EXTERIOR

CONTENTS

GENERAL	2	FRONT BUMPER	3
Outline of Changes	2	AERO PARTS	5
ADHESIVES	2	MARKS	7
SPECIAL TOOL	2	DOOR MIRRORS	9



GENERAL

OUTLINE OF CHANGES

- The following service procedures have been added to correspond to the addition of an aero-type front bumper.
- Due to the installation of rear spoiler <Sedan> and tailgate deflector <Wagon>, the service procedures have been added.
- Due to the installation of the large side sill cover, the service procedures have been added.
- Due to the installation of the side decal and grade mark, the service procedures have been added.
- Due to the installation of the door mirrors with electric folding function and heated printing, the inspection procedures have been added.

ADHESIVES

Items	Specified adhesive
Tailgate deflector	Adhesive tape: Double-sided tape (8 mm width and 0.8 mm thickness)
Side sill cover	Adhesive tape: Double-sided tape (4 mm width and 0.8 mm thickness)

SPECIAL TOOL

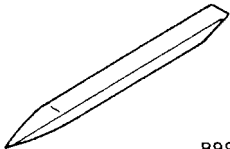
Tool	Number	Name	Use
 8990784	MB990784	Ornament remover	Front bumper, rear spoiler <Sedan>, tailgate deflector <Wagon> and side sill cover removal

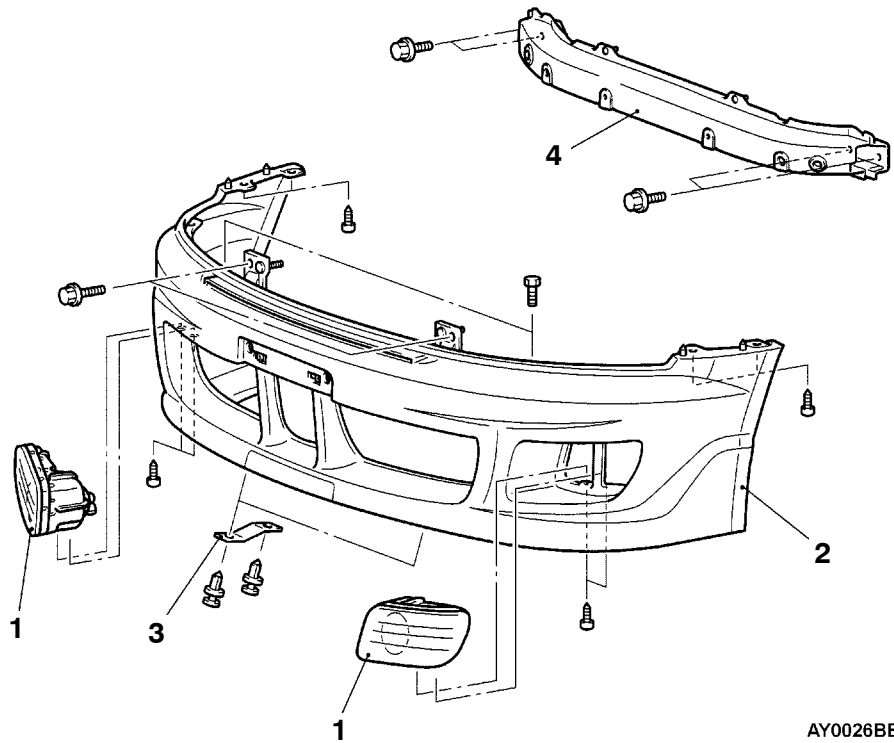
FRONT BUMPER**REMOVAL AND INSTALLATION**

AY0026BE

Removal Steps

1. Fog lamp assembly
2. Front bumper assembly
3. Front bumper lower bracket
4. Front bumper reinforcement assembly

DISASSEMBLY AND REASSEMBLY

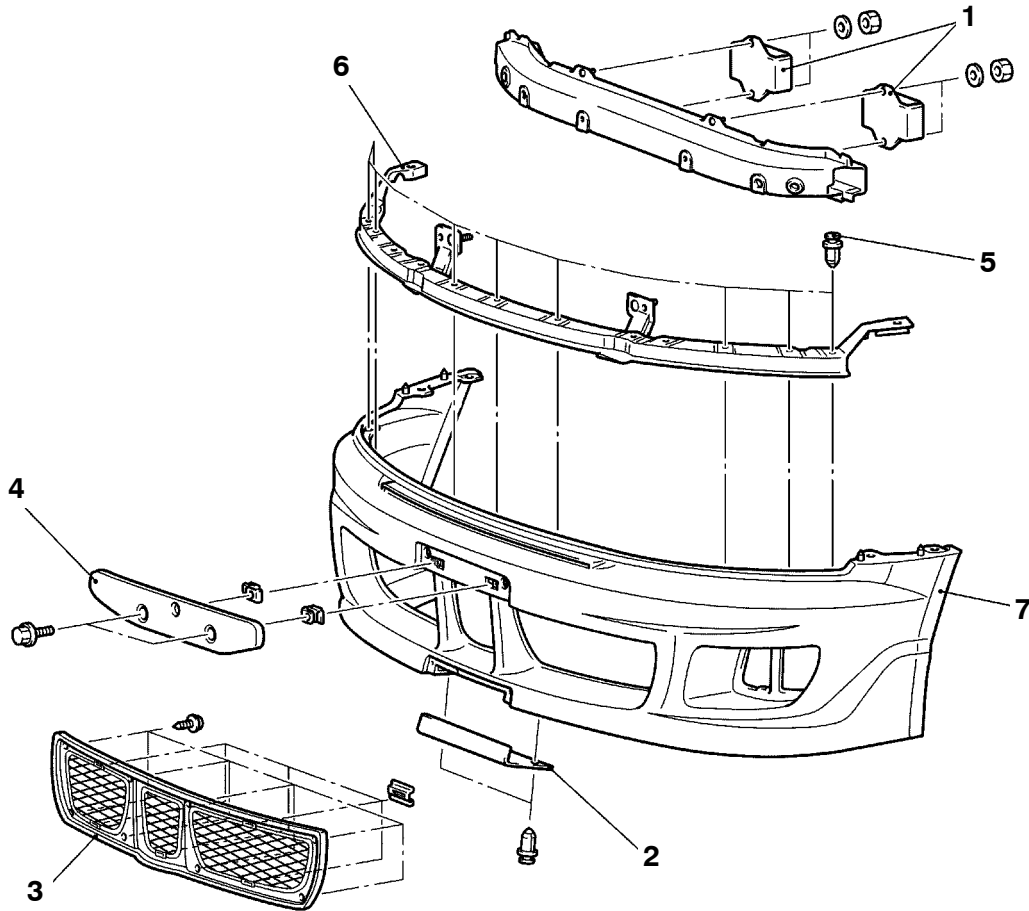

AY0027BE

Disassembly Steps

1. Dynamic damper assembly
<Vehicles with 4G64-GDI engine>
2. Front bumper lower cover
3. Under grille

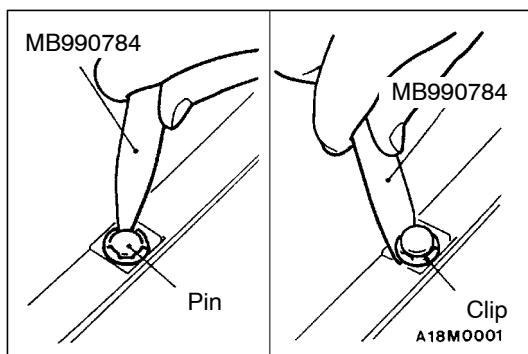

4. Licence plate bracket
5. Clip
6. Front bumper upper reinforcement
7. Front bumper face

**DISASSEMBLY SERVICE POINT****◀A▶ REMOVAL OF CLIP**

1. Use the special tool to pull up the center pin in the clip.
2. Remove the clip.

AERO PARTS

REMOVAL AND INSTALLATION

<Sedan>

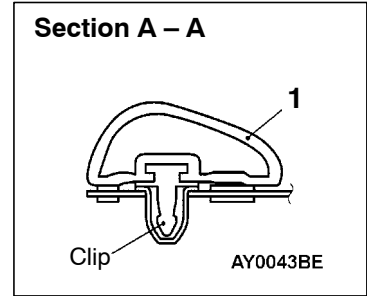
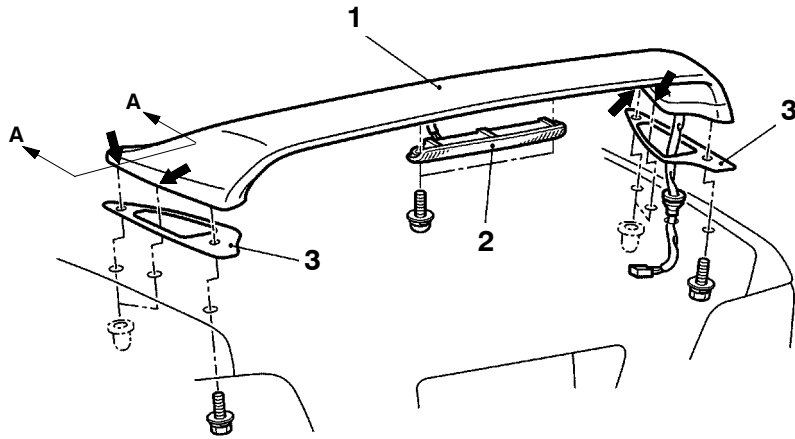

AY0041BE

<Wagon>

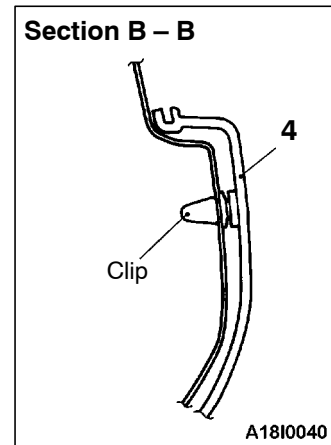
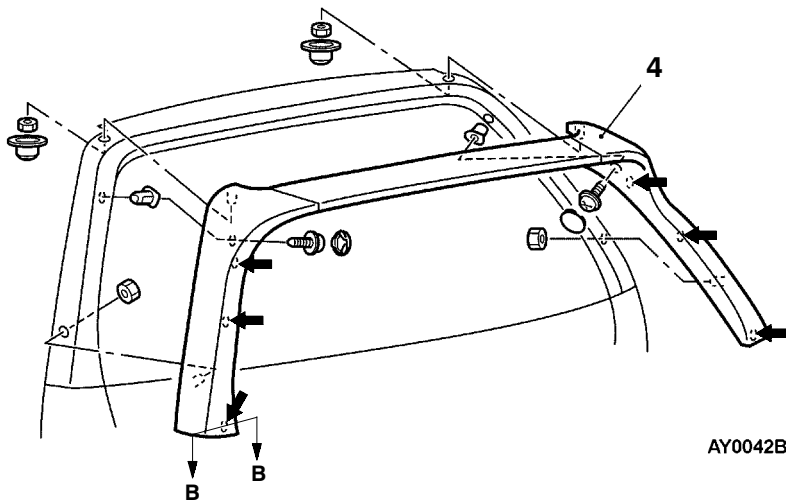

AY0042BE

A18I0040

NOTE

← : Clips positions

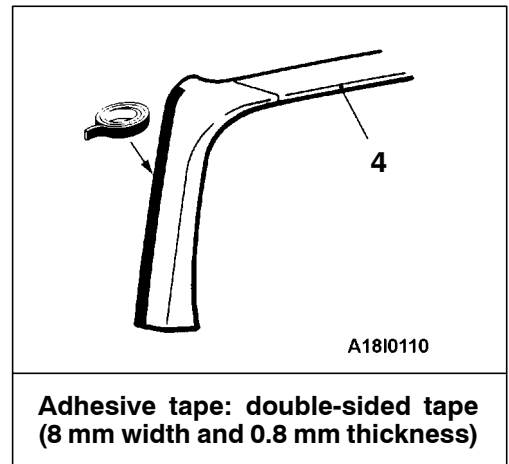

A18I0110

Adhesive tape: double-sided tape
(8 mm width and 0.8 mm thickness)

Removal Steps

1. Rear spoiler assembly
2. High mounted stop lamp assembly
(Refer to GROUP 54A.)

3. Packing
 - Side tailgate trim <Wagon>
4. Tailgate deflector assembly



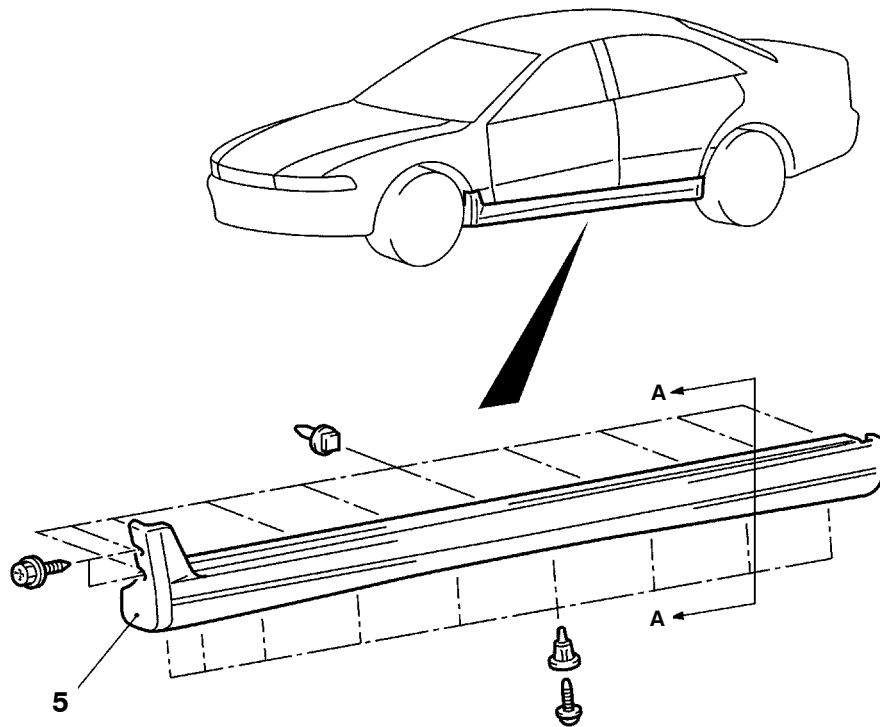

AY0038BE

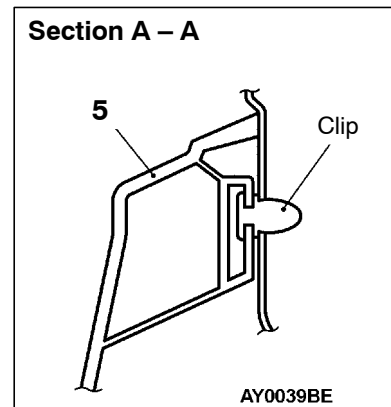
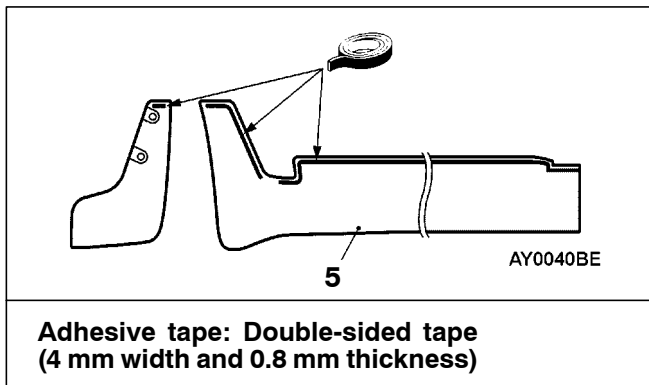
**Removal Step**

◀A▶ ▶A◀ 5. Side sill cover

REMOVAL SERVICE POINT**◀A▶ REMOVAL OF TAILGATE DEFLECTOR ASSEMBLY AND SIDE SILL COVER**

The same procedures as that of removal of side protect moulding are applied. [Refer to '97 GALANT Workshop Manual GROUP 51 - Mouldings.]

INSTALLATION SERVICE POINT**▶A◀ INSTALLATION OF TAILGATE DEFLECTOR ASSEMBLY AND SIDE SILL COVER**

The same procedures as the installation of side protect moulding are applied. [Refer to '97 GALANT Workshop Manual GROUP 51 - Mouldings.]

MARKS

REMOVAL AND INSTALLATION

<Sedan>

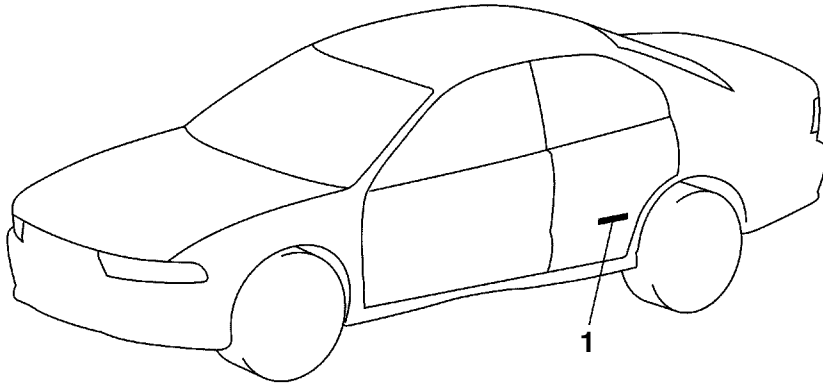

AY0035BE

<Wagon>

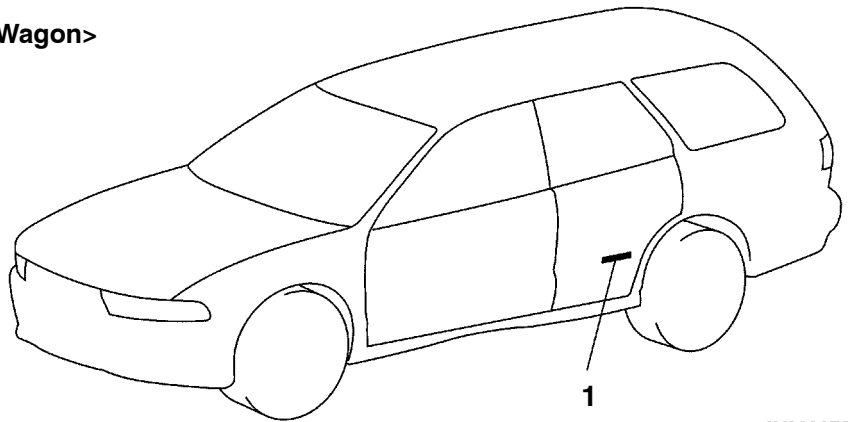

AY0036BE

<Sedan>

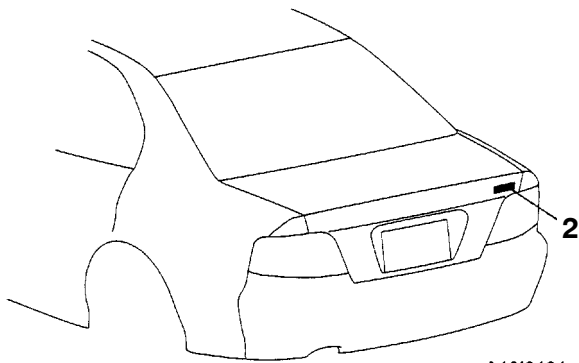

A1810181

<Wagon>

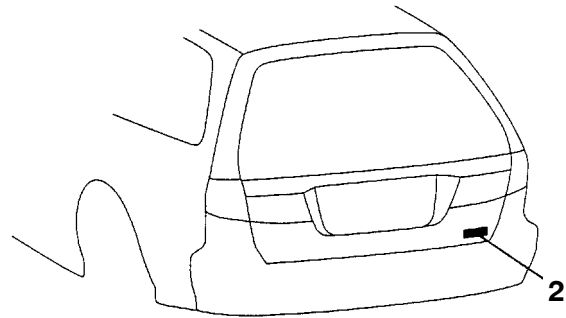

B1810182

- ▶▶ A ◀◀ 1. Side decal
- ▶▶ A ◀◀ 2. Grade mark

INSTALLATION SERVICE POINT

▶A◀ INSTALLATION OF MARKS

1. APPLICATION POSITION

(1) Side decal

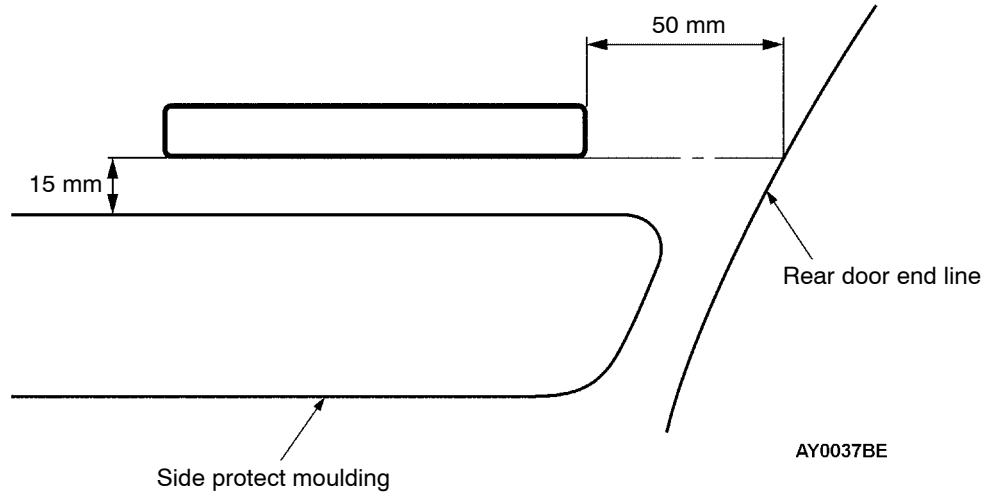

NOTE
The illustration shown above indicates the left side.
The right side is symmetrical.

(2) Grade mark

<Sedan>

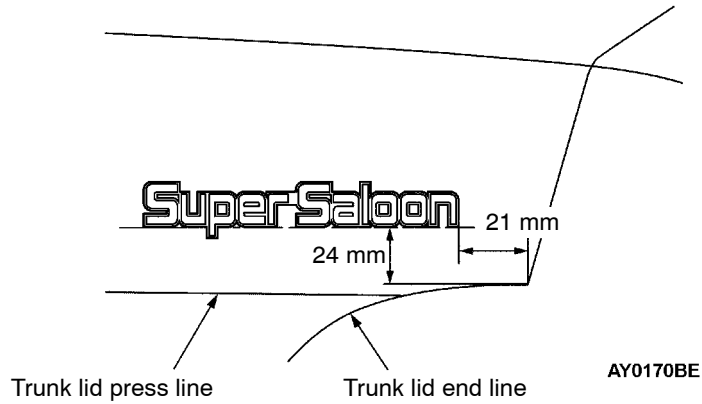

<Wagon>

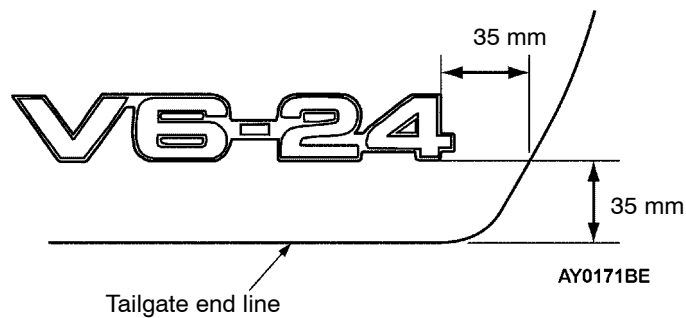

2. INSTALLATION PROCEDURE

- (1) Clean the mark installation surfaces on the body with unleaded petrol.
- (2) Peel off the backing paper from the reverse side of the marks, and then attach the marks to the vehicle body so that they fit properly into position.

Caution

When attaching the marks, the surrounding temperature should be 20 - 38°C and the air should be completely free from dust.

If the surrounding temperature is lower than 20°C, the marks and the places on the body where the marks are to be attached should be heated to 20 - 38°C. Make sure not to let air bubbles into the tape when pasting marks.

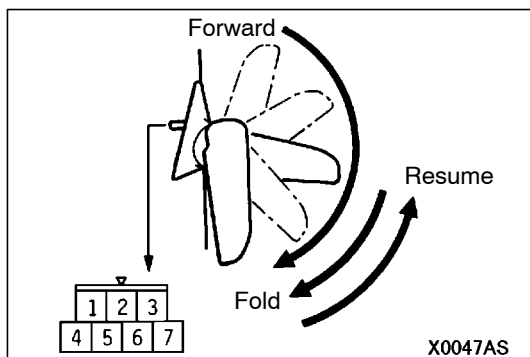

DOOR MIRRORS

INSPECTION

MOTOR-DRIVEN REMOTE CONTROLLED MIRROR OPERATION CHECK

Battery connection terminal					Direction of operation
2	3	5	6	7	
		⊖		⊕	UP
		⊕		⊖	DOWN
		⊕	⊖		LEFT
		⊖	⊕		RIGHT
⊕	⊖				Resume or Forward → Fold position
⊖	⊕				Fold → Resume position

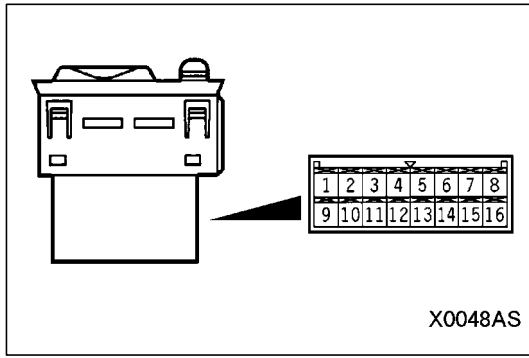

MOTOR-DRIVEN REMOTE CONTROLLED MIRROR SWITCH CONTINUITY CHEK

Switch	Switch position	Terminal No.															
		Left side					Right side					1	2	8	11	7	10
		1	4	5	8	16	1	3	5	6	8						
Mirror adjustment switch	Up				○—○	○—○				○—○	○—○						
	Down	○—○		○—○	○—○				○—○	○—○							
	Left	○—○		○—○	○—○			○—○		○—○							
	Right		○—○	○—○	○—○			○—○	○—○	○—○							
Mirror folding switch	Resume											○—○	○—○	○—○			
	Fold											○—○	○—○	○—○			
illumination															○—○	ILL	

NOTE

Since a mirror folding switch adopts a holding type switch with 3 positions (Resume, Neutral, Fold), the position will not automatically return to the Neutral position after pressing the resume switch or fold switch.

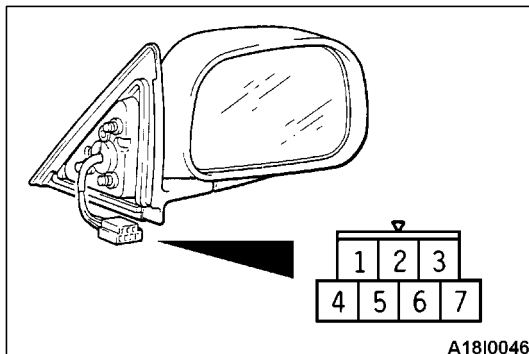

THERMAL PRINTED WIRE FUNCTION CHECK

Check that there is continuity between terminals No.1 and No.4.